

Inset 5A (Scale 1:2500)

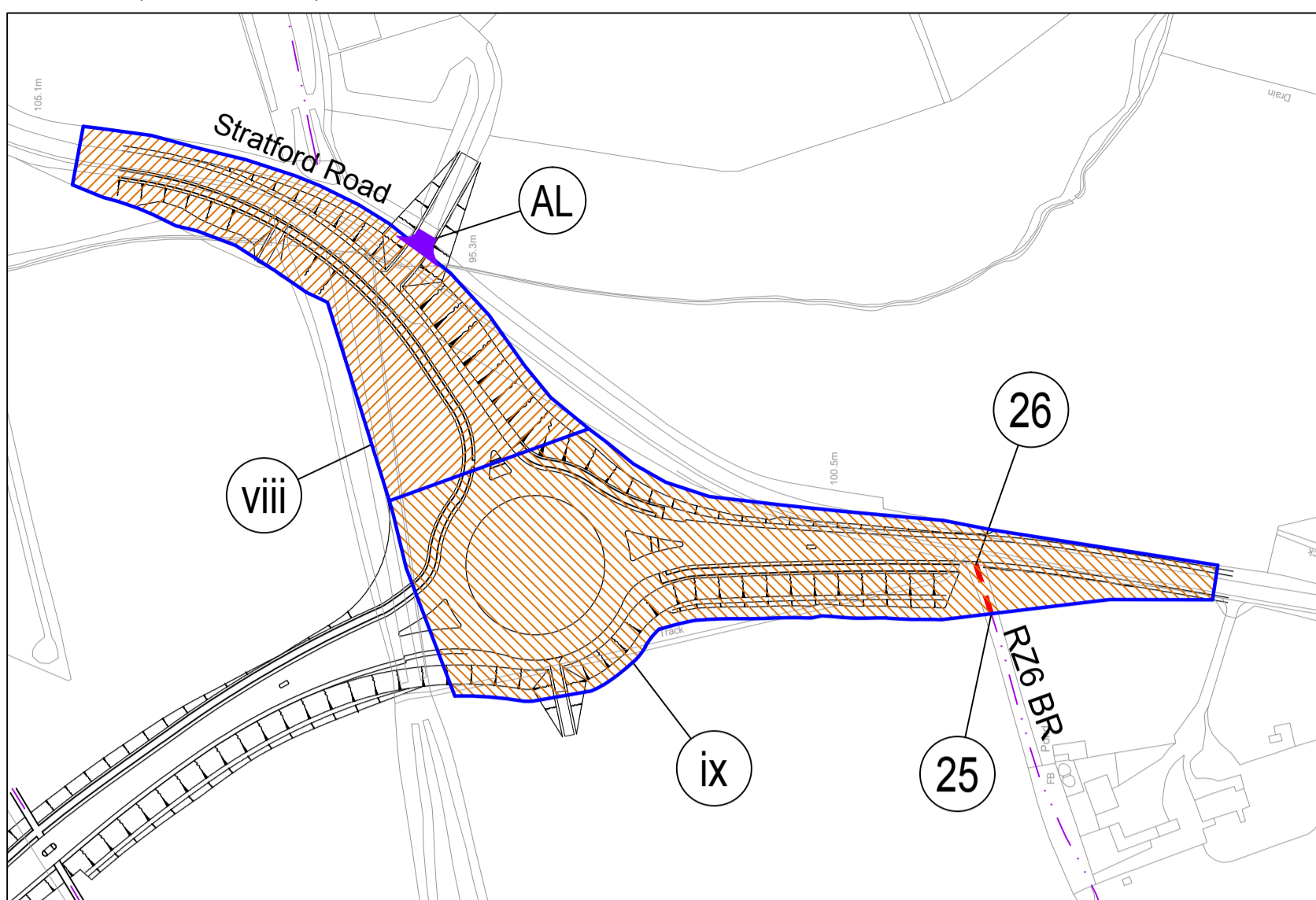

Inset 5B (Scale 1:2500)

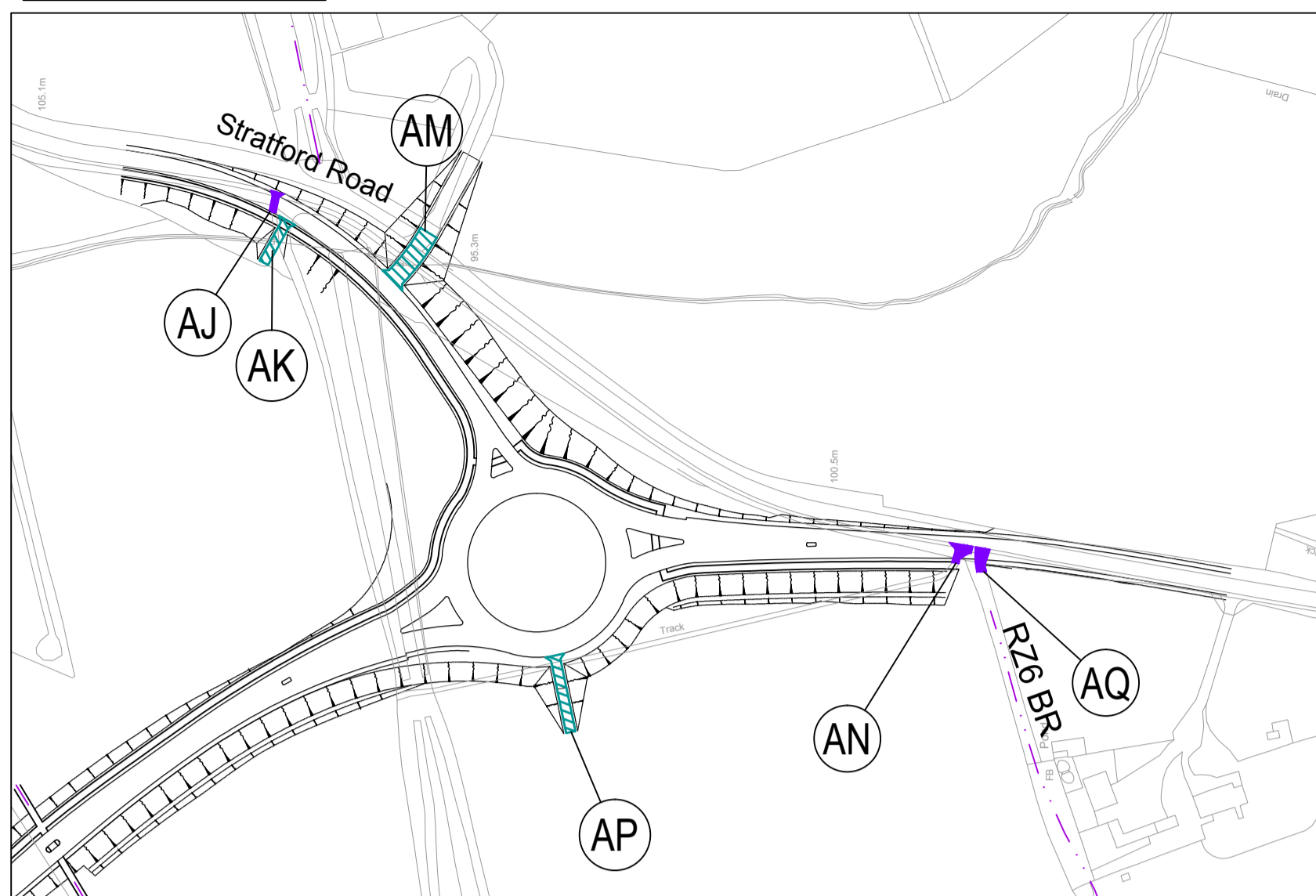

See also Insets 5A & 5B above

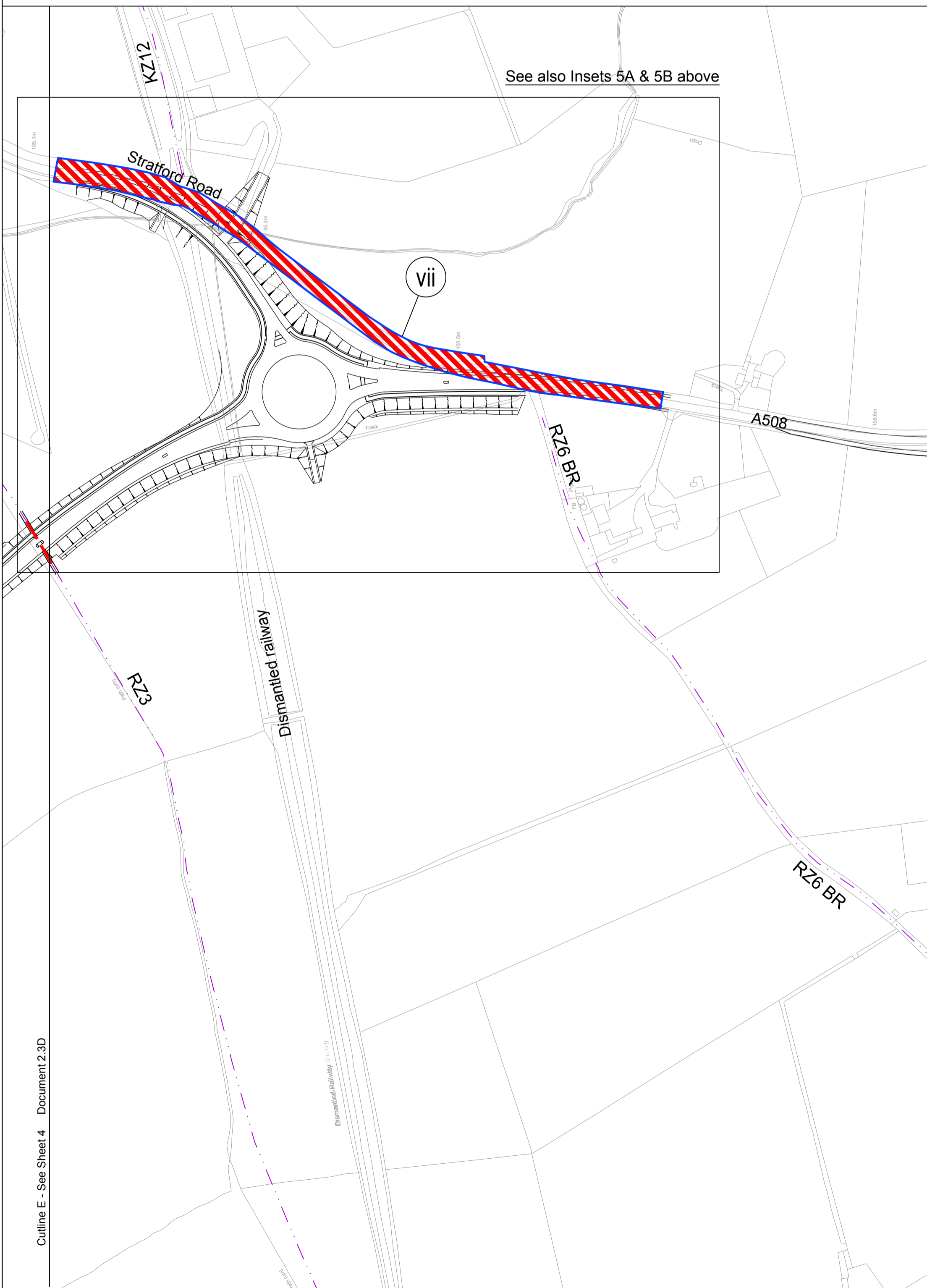

See also Insets 5C & 5D below

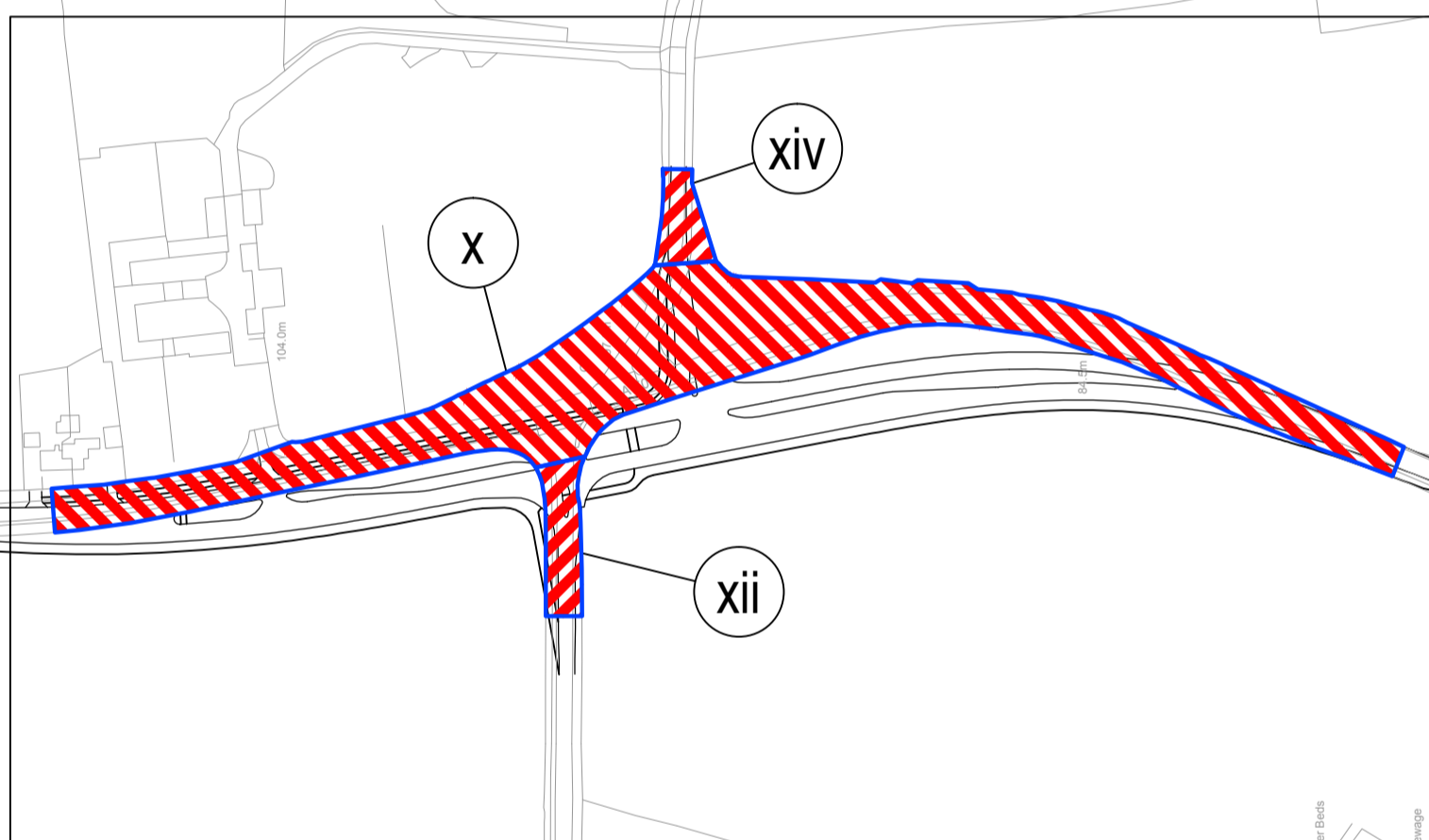

Inset 5D (Scale 1:2500)

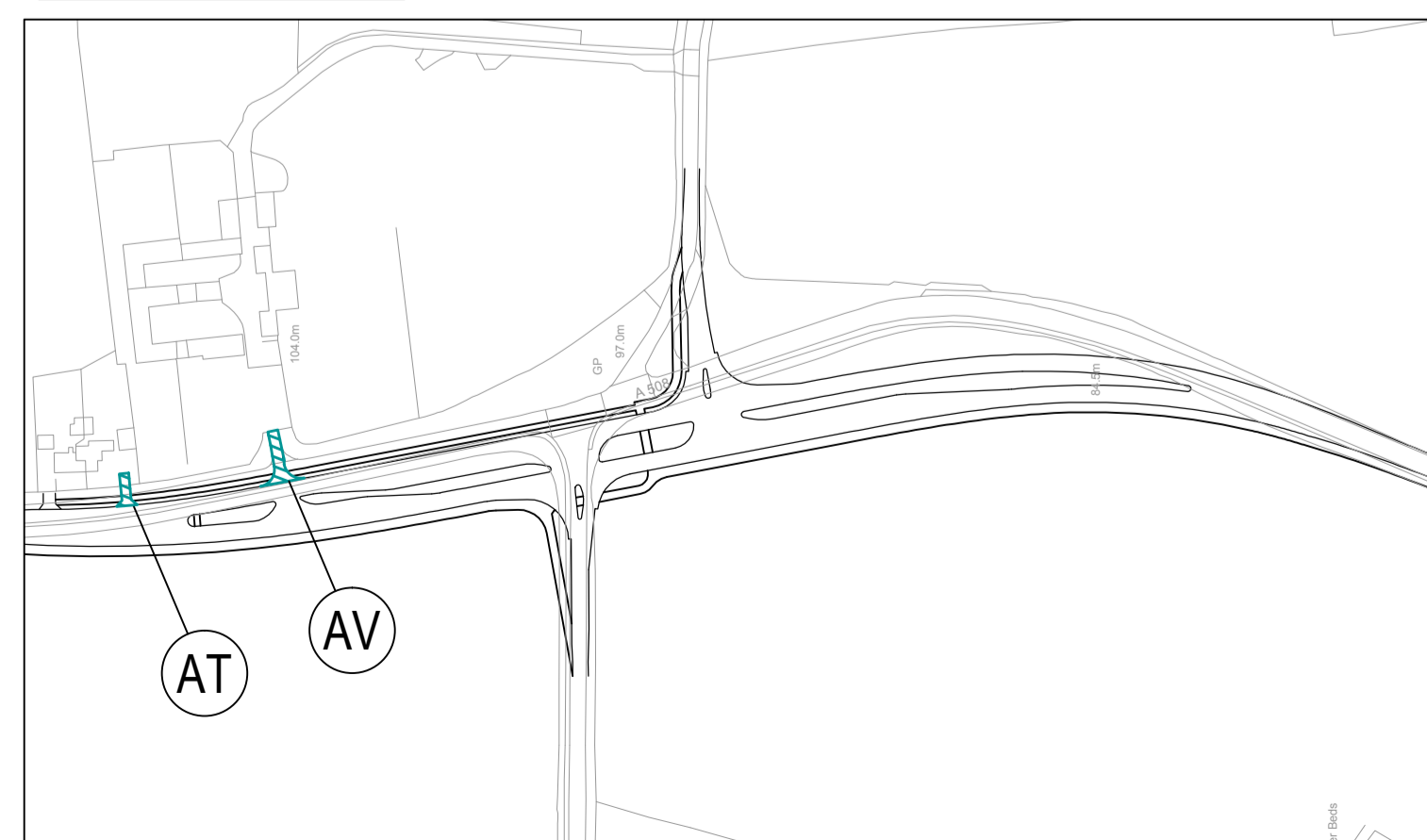

Inset 5C (Scale 1:2500)

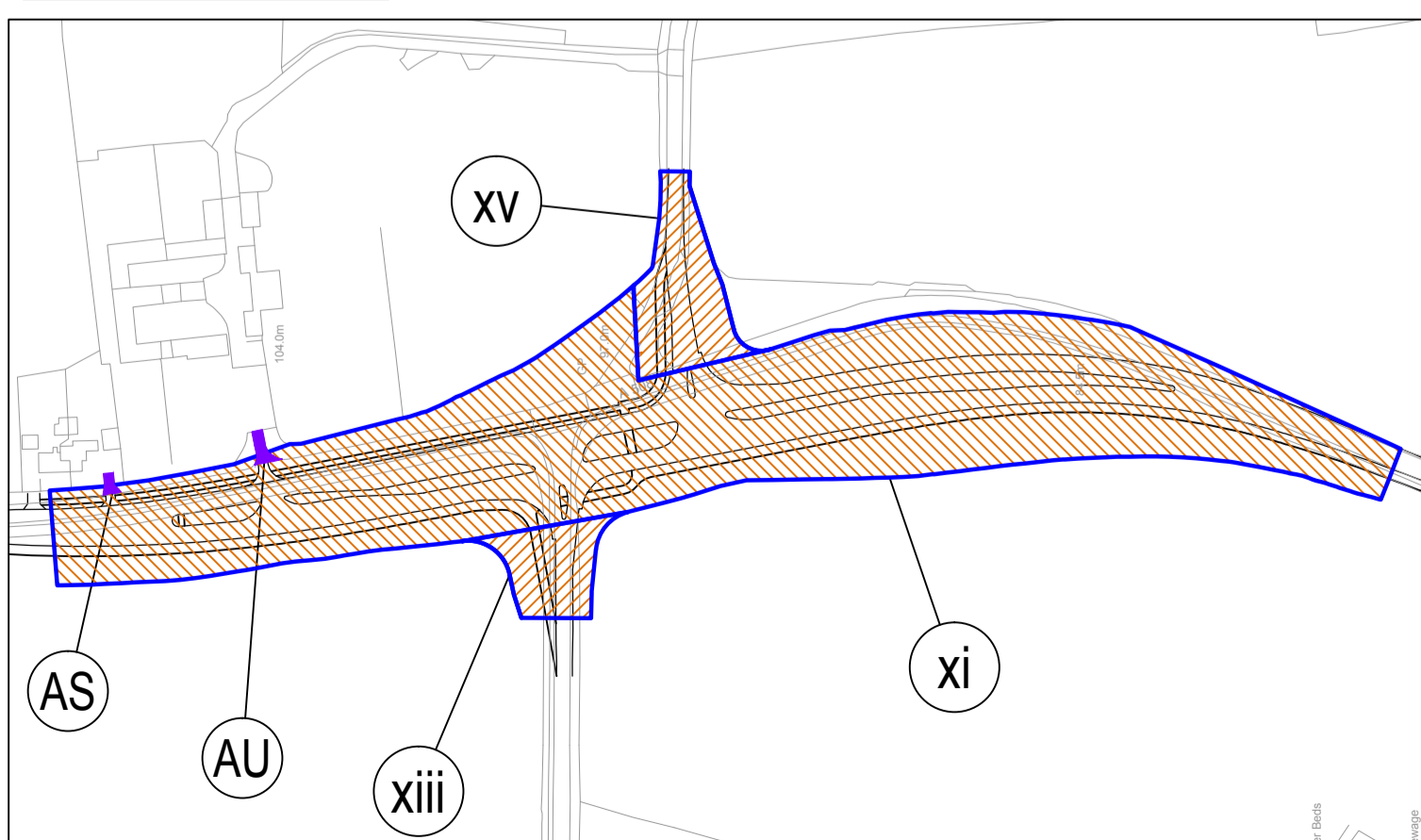

Legend

- EXISTING HIGHWAY TO BE STOPPED UP
- DIVERTED MOTORWAY SPECIAL ROAD
- DIVERTED ALL PURPOSE LOCAL HIGHWAY
- EXISTING PRIVATE MEANS OF ACCESS STOPPED UP
- NEW PRIVATE MEANS OF ACCESS
- EXISTING PUBLIC RIGHT OF WAY RETAINED
- EXISTING PUBLIC RIGHT OF WAY STOPPED UP
- NEW PUBLIC FOOTPATH CREATED
- NEW PUBLIC BRIDLEWAY CREATED
- NEW CYCLE TRACK CREATED (ALL PURPOSE HIGHWAY FOR USE BY PEDESTRIANS AND CYCLISTS ONLY)
- ROMAN NUMERAL REFERENCE LABELS: REFER TO SCHEDULE 4 OF THE DEVELOPMENT CONSENT ORDER
- NUMERIC REFERENCE LABELS: REFER TO SCHEDULE 5 OF THE DEVELOPMENT CONSENT ORDER
- ALPHABETIC REFERENCE LABELS: REFER TO SCHEDULE 6 OF THE DEVELOPMENT CONSENT ORDER
- ADMINISTRATIVE BOUNDARY BETWEEN SOUTH NORTHAMPTONSHIRE DISTRICT AND BOROUGH OF NORTHAMPTON

THE LEGEND IS IDENTICAL ON ALL SHEETS OF THE ACCESS AND RIGHTS OF WAY PLANS AND THEREFORE NOT ALL ITEMS DETAILED IN THE LEGEND ARE REPRESENTED ON EACH SHEET

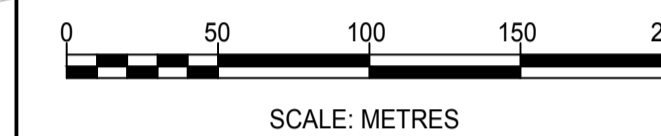

Rev	Date	Details of issue / revision	Drw	Rev
P5	27.04.18	Issued for Submission	SRH	SRH
P4	16.03.18	Scheme review	SRH	SRH
P3	28.02.18	Minor corrections	SRH	SRH
P2	26.01.18	Updates following Stage 2 consultation	GDJ	SRH
P1	27.09.17	Preliminary Issue	GDJ	SRH

ISSUES & REVISIONS

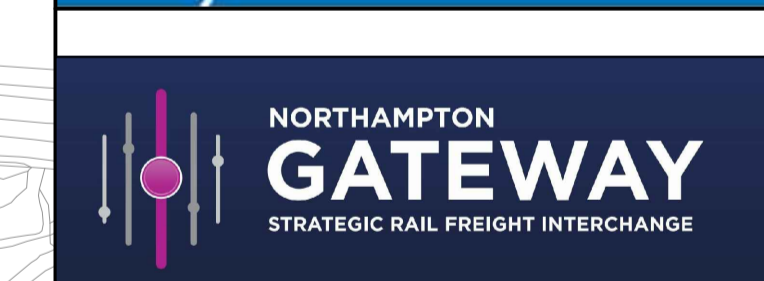

THE NORTHAMPTON GATEWAY RAIL FREIGHT INTERCHANGE ORDER 201X

ACCESS AND RIGHTS OF WAY PLANS SHEET 5 OF 5

Scale	1:2,500	Drawn	G.Jones
Size	A1	Reviewed	S. Hilditch
Regulation	5(2) (k)	Document	2.3E

Drawing Status
SUBMISSION

Drawing No.
NGW-BWB-LSI-05-DR-C-00175

Revision
P5